

Machanical assessories

Syphon tube series MA.94

Syphon tube
Accessories for pressure instrument

General features

- Accessories for pressure instrument
- Cooling element for protection from excessive heating of liquids, gases and vapours.

Application area

The geometries of the syphons in accordance with DIN 16282 are divided into U-form and trumpet form. Inside the syphon, condensate is collected, which prevents the ingress of hot media into the pressure measuring instrument. It is recommended to fill the syphon with a cooling separating liquid before commissioning the pressure line.

General specification

Shape

U-form : horizontal tapping

Trumpet-form : Vertical pressure tapping

Material

St. steel

Others on request

Gauge connection

PF1/2" female+ PF1/2" male

Others on request

Process connection

PF1/2" female+ PF1/2" male

Weld-in

Others on request

Pipe

3/8"(8A, ϕ 17.3), SCH.40 (2.3t)

3/8"(8A, ϕ 17.3), SCH.80 (3.2t)

1/2"(15A, ϕ 21.7), SCH.40 (2.9t)

1/2"(15A, ϕ 21.7), SCH.80 (3.9t)



Mechanical accessories, series MA.94

Dimension

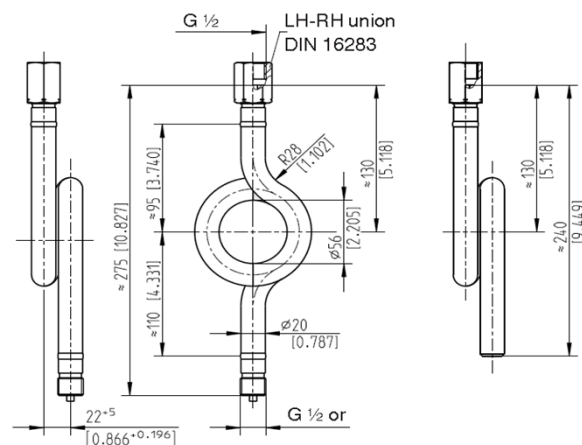

DAHO

Daho Tronic Ltd.

STX W-Tower 209

Gyeongin-ro 53Gil 90 Guro-gu

Seoul 08215 Korea

Tel: +82 2 865-7001 Fax: +82 2 865-7109

info@daho.co.kr

www.daho.co.kr